

Product Data Specification

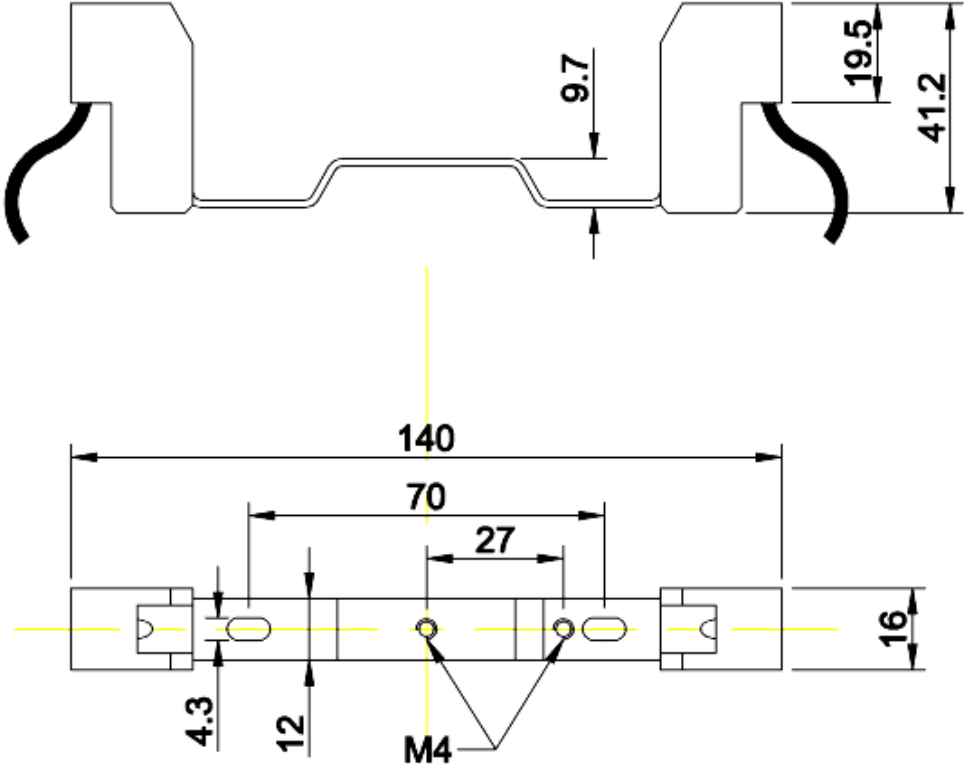

Technical Data

All dimensions in mm unless otherwise stated

- Lamp holder rating: 6 amps at 250v
- Cable: 0.75mm² PTFE or equivalent. Max temperature 250° C
- Cable length 250
- Ceramic insulating end blocks
- Solid contacts
- Backbone to have strengthening indents on corners to reducing bending

K515F R7s Lamp holder	Authorised By
-----------------------	---------------